



# FALCON

By

**BHP Housing**



# ELEVATE YOUR LIFESTYLE

## WELCOME TO FALCON

An upcoming residential marvel nestled in the fast developing locality of Bangalore. Boasting a perfect blend of modern architecture, exquisite design, and a host of luxurious amenities, Falcon sets the stage for an unparalleled living experience.





# FALCON THE EPITOME OF OPULENT LIVING



Elevate Your Living with Falcon,  
Where Luxury Takes Flight

A commitment to quality and attention to detail, Falcon offers a lifestyle beyond compare.



# MASTER PLAN

1. STP and transformer yard
2. Children play area
3. Cricket practice net
4. Parks
5. Half basketball court
6. Badminton court
7. Amphitheater
8. Water Softener Plant
9. Outdoor Gym
10. Swimming pool with Kids pool
11. Club House
  - a. Indoor Gym
  - b. Indoor Games
  - c. Multi Purpose Party Hall

No. of Flats	276 Flats
No. of Floors	18
Parking	Basement & Ground Floor
Lifts	4





## ARCHITECTURAL BRILLIANCE AND DESIGN PHILOSOPHY

At Falcon, architectural brilliance takes center stage. Every aspect of the design is meticulously crafted to create a harmonious blend of aesthetics and functionality.

The architectural vision behind Falcon reflects a perfect fusion of modern innovation and timeless elegance, creating a living space that exudes sophistication and charm.

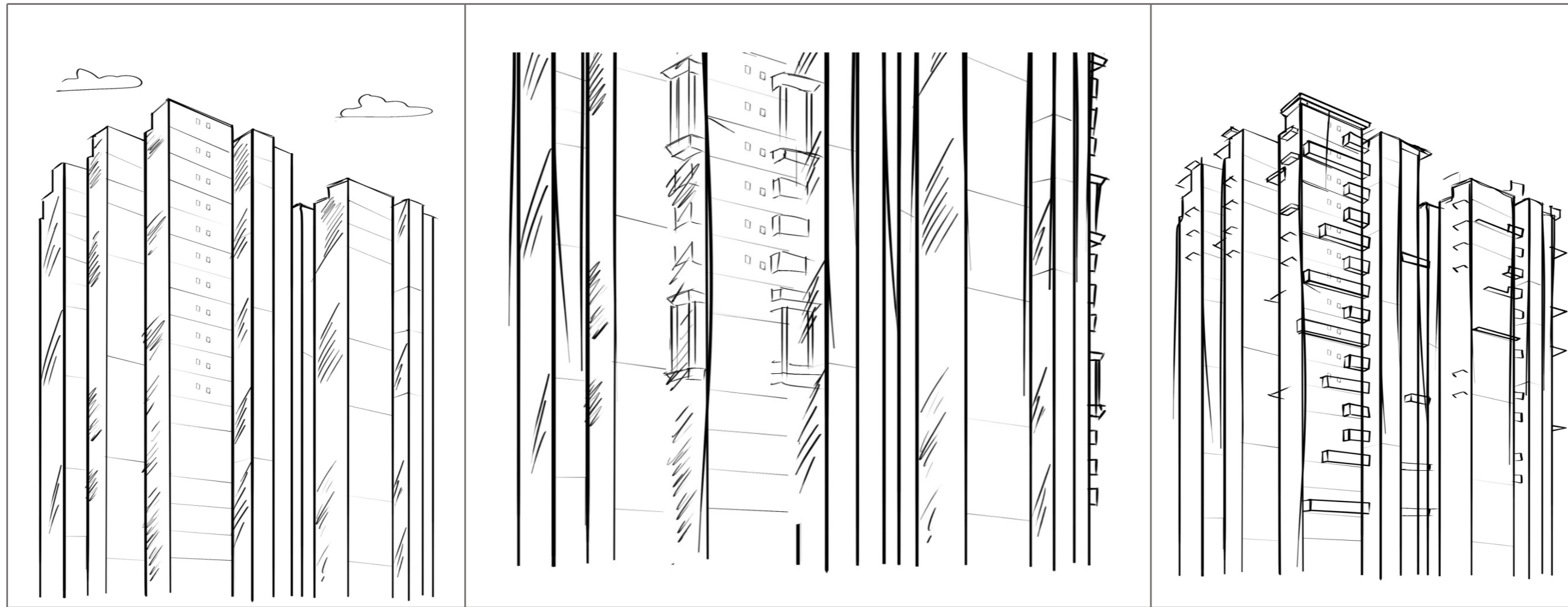

## UNPARALLELED CONSTRUCTION QUALITY

At Falcon, we believe in delivering nothing but the best. Our unwavering commitment to uncompromising construction quality sets us apart.

From the foundation to the finishing touches, every aspect of construction undergoes rigorous scrutiny to ensure durability, safety, and longevity.

# ISOMETRIC VIEW

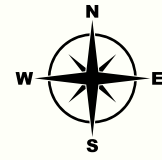

Floors	3,5,8,10,12,15,17
Flat No	2,10
Type	3 BHK
Facing	East
Carpet Area	741 sft
SBA	1050 sft
Private Terrace	49 sft

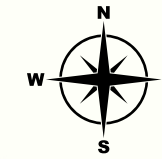

Floors	3,10,17
Flat No	7,15
Type	3 BHK
Facing	North
Carpet Area	740 sft
SBA	1055 sft
Private Terrace	70 sft

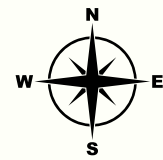

Floors	3,5,8,10,12,,15,17
Flat No	13
Type	2 BHK
Facing	North
Carpet Area	639 sft
SBA	915 sft

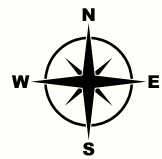

Floors	3,10,17
Flat No	8,16
Type	3 BHK
Facing	East
Carpet Area	741 sft
SBA	1050 sft
Private Terrace	139 sft

# ISOMETRIC VIEW



Floors	3,5,8,10,12,15,17
Flat No	12
Type	2 BHK
Facing	East
Carpet Area	654 sft
SBA	933 sft
Private Terrace	51 sft

# FLOOR PLAN



Floors	2nd to 17th
Flat No	1,9
Type	3 BHK
Facing	North
Carpet Area	740 sft
SBA	1055 sft

Floors	2,4,6,7,9,11,13,14,16
Flat No	2,8,10,16
Type	3 BHK
Facing	East
Carpet Area	741 sft
SBA	1050 sft





Floors	2,4,6,7,9,11,13,14,16
Flat No	3
Type	2 BHK
Facing	West
Carpet Area	639 sft
SBA	915 sft



Floors	2,4,6,7,9,11,13,14,16
Flat No	5
Type	2 BHK
Facing	North
Carpet Area	639 sft
SBA	915 sft

Floors	2nd to 17th
Flat No	4
Type	2 BHK
Facing	East
Carpet Area	654 sft
SBA	933 sft



Floors	2nd to 17th
Flat No	6
Type	2 BHK
Facing	North
Carpet Area	654 sft
SBA	933 sft





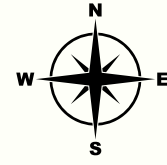

Floors	2,4,6,7,9,11,13,14,16
Flat No	7,15
Type	3 BHK
Facing	North
Carpet Area	740 sft
SBA	1055 sft

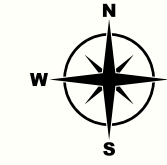

Floors	3,5,8,10,12,15,17
Flat No	3
Type	2 BHK
Facing	West
Carpet Area	639 sft
SBA	915 sft
Private Terrace	19 sft

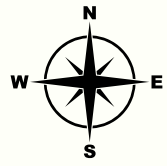

Floors	3,5,8,10,12,15,17
Flat No	5
Type	2 BHK
Facing	North
Carpet Area	639 sft
SBA	915 sft
Private Terrace	19 sft

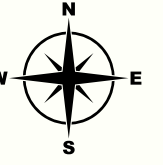

Floors	3,5,8,10,12,15,17
Flat No	2,10
Type	3 BHK
Facing	East
Carpet Area	741 sft
SBA	1050 sft
Private Terrace	49 sft

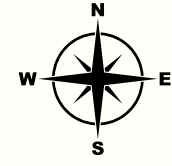

Floors	3,10,17
Flat No	7,15
Type	3 BHK
Facing	North
Carpet Area	740 sft
SBA	1055 sft
Private Terrace	70 sft

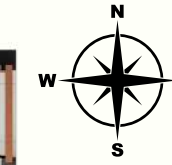

Floors	3,5,8,10,12,15,17
Flat No	12
Type	2 BHK
Facing	East
Carpet Area	654 sft
SBA	933 sft
Private Terrace	51 sft

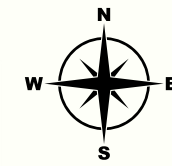
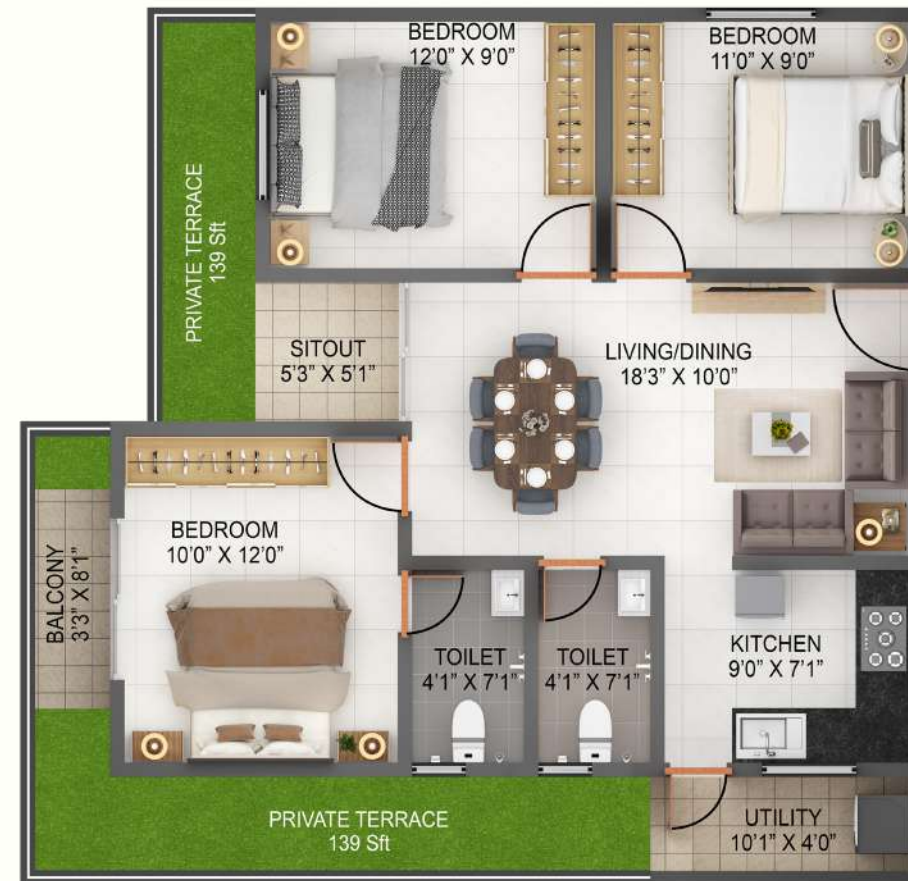

Floors	3,10,17
Flat No	8,16
Type	3 BHK
Facing	East
Carpet Area	741 sft
SBA	1050 sft
Private Terrace	139 sft

Floors	3,5,8,10,12,15,17
Flat No	14
Type	2 BHK
Facing	North
Carpet Area	654 sft
SBA	933 sft
Private Terrace	51 sft

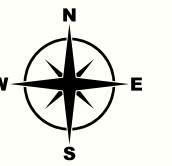



Floors	5,8,12,15
Flat No	7,15
Type	3 BHK
Facing	North
Carpet Area	740 sft
SBA	1055 sft
Private Terrace	48 sft

Floors	5,8,12,15
Flat No	8,16
Type	3 BHK
Facing	East
Carpet Area	741 sft
SBA	1050 sft
Private Terrace	79 sft

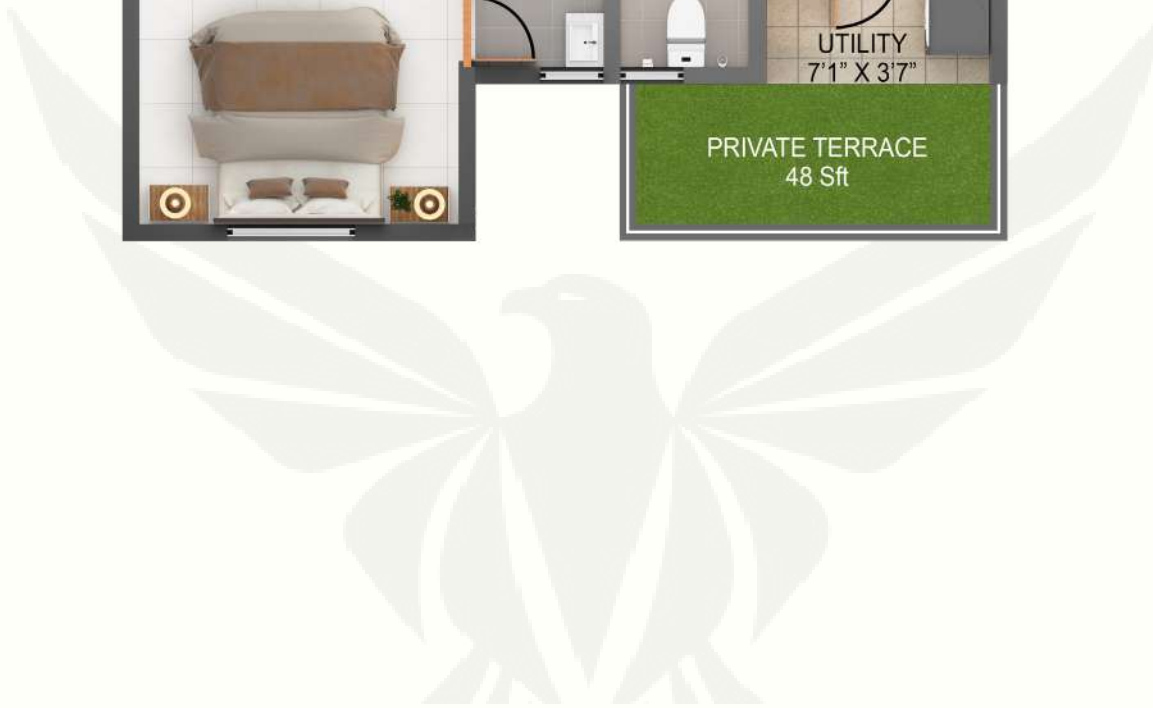
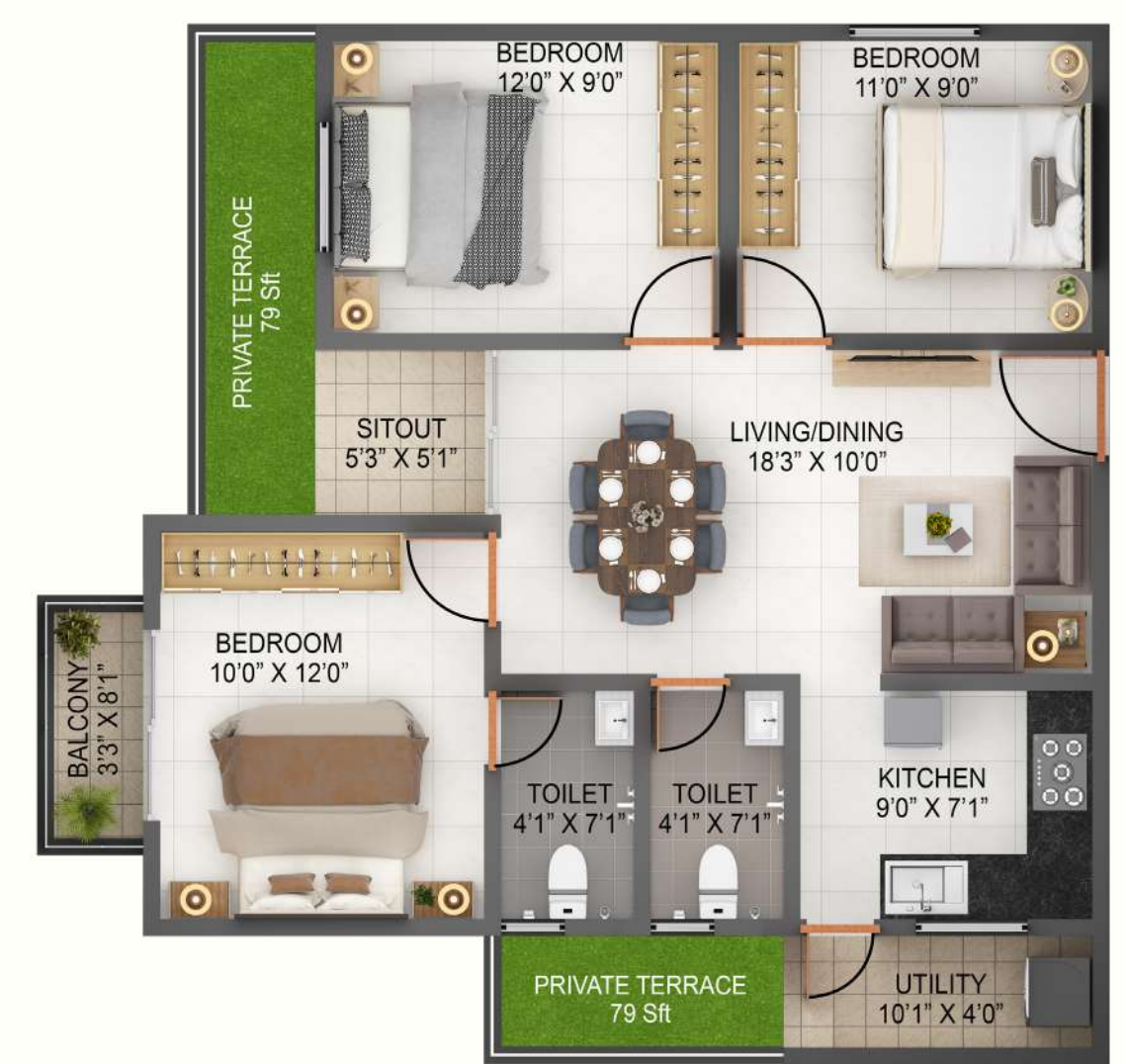



# AMENITIES



Cricket Practice Net



Children Play Area

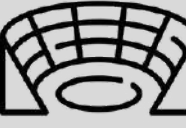

Amphitheatre



Swimming Pool with kids pool



Half Basket Ball Court



Badminton Court



24/7 Security with CCTV



Landscape Park

## CLUB HOUSE AMENITIES



Indoor Gym



Indoor Games



Multipurpose Party Hall



# NEARBY FACILITIES

## EDUCATIONAL INSTITUTIONS

- ISME International School
- Azim Premji University
- Oakridge International School
- Delhi Public School
- Greenwood International School
- Manipal International School
- Oxford Medical College and Hospital
- Indus International School

## SHOPPING

- Decathlon
- D- Mart
- More Supermarket
- Food City Hyper Market

## FOOD COURT & RESTAURANTS

- KFC
- Dominos
- Pizza Hut
- Mani's Dum Biryani

## TECH PARKS

- Sabic Technology Center
- RGA Tech Park
- Wipro New Campus
- RMZ ECO Space
- Infosys

## HOSPITALS

- Swastic Hospital
- Manipal Hospital
- Motherhood Hospital
- Narayana Hrudayalaya

## MALLS

- Forum Prestige City mall (upcoming)
- Total Mall
- Confident Oxygen Mall
- Nature Walk Mall





# SPECIFICATIONS

## Structure & Walls

R.C.C framed Structure (Aluminum form work concrete walls) with M-45 grade concrete and FE 550 D Grade TMT steel, designed as per relevant BIS Code for earth quake resistance (seismic Zone-II), structurally efficient systems implemented

## Doors

Main entrance door and Bed Rooms are engineered wood frames and shutters finished and other doors are WPVC doors

## Windows

UPVC sliding windows with mosquito mesh

## Flooring

Polished vitrified tiles flooring with 4" skirting in drawing, kitchen, dining and bedrooms  
Anti -skid ceramic tiles for balconies with RAK, Kajaria, Hindware or Equivalent Brand

## Generator

Power Back -up provided with load controller for each flat  
Additional power back up for water pump and common area lightings

## Kitchen

Glazed tiles dadoing upto 2'0" height

## Toilets

Anti-skid ceramic tiles flooring and glazed ceramic tiles dadoing up to 8'0"  
Jaquar or Totto or equivalent make ISI CP and sanitary fittings

## Plumbing

CPVC water Supply Lines

## Electrification

Anchor or equivalent make

## Communication

TV points in living room

## Lift

1. Lift with a capacity of 10 passengers of Schindler make (Quantity 2 Nos)
2. Lift with a capacity of 16 passengers of Schindler make (Quantity 2 Nos)

# LOCATION MAP

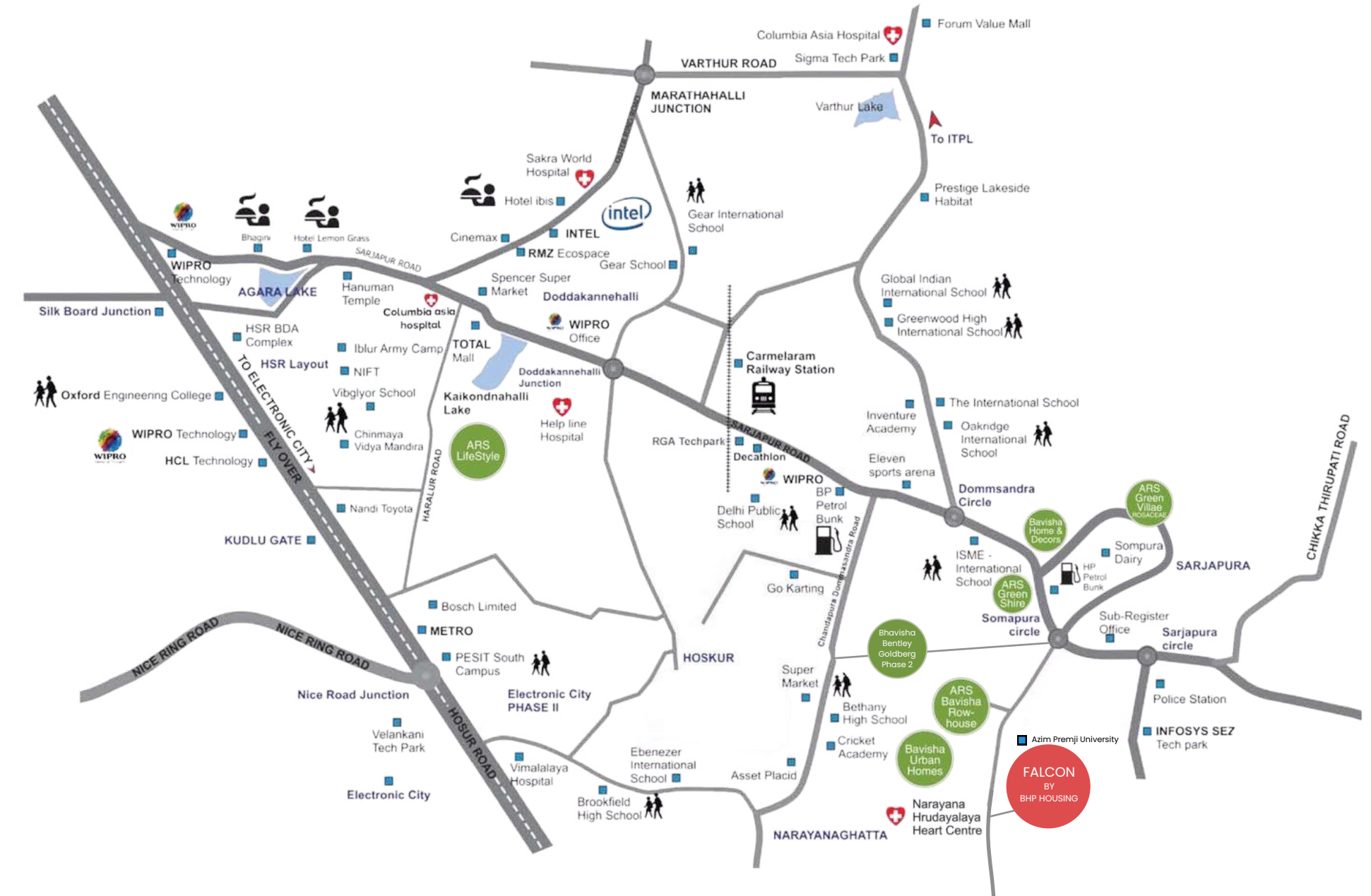



FALCON

by

BHP Housing

#001, 3rd Floor, Sy No. 55/1, Yamare,  
Sarjapur Road, Bengaluru,  
Karnataka - 562 125

Website: [www.bhavishahomes.com](http://www.bhavishahomes.com)

Email: [bhphousing@gmail.com](mailto:bhphousing@gmail.com)